

# SY 24-25 Bell Schedules



**ELEMENTARY SCHOOLS**  
**(July 15, 2024)**

# SY 24-25 Bell Schedule



## Adacao Elementary School

## SY2024-2025 SCHOOL BELL SCHEDULE



### PRIMARY (Kindergarten)

<b>7:30 – 8:15</b>	<b>Breakfast is Served</b>
<b>8:15 – 8:30</b>	<b>Classroom Morning Routine</b> <b>(Sanitizing Hands, Attendance, Recitation of Star Spangled Banner/Guam Hymn &amp; Pledge, Vision &amp; Mission Statement, SLOs, Announcements)</b>
<b>8:25</b>	<b>Students will be picked up by ESL/Special Programs Teachers</b> <b>(If applicable)</b>
<b>8:30 – 9:00</b>	<b>Writer's Window</b>
<b>9:00 – 9:30</b>	<b>CHAMORU</b>
<b>9:30 – 10:00</b>	<b>Language</b>
<b>10:00 – 10:30</b>	<b>Reading</b>
<b>10:30 – 11:15</b>	<b>LUNCH</b>
<b>11:15 – 11:45</b>	<b>Reading</b>
<b>11:45 – 12:45</b>	<b>Math</b>
<b>12:45 -1:30</b>	<b>Science</b>
<b>1:30 – 1:45</b>	<b>RECESS</b>
<b>1:45 - 2:43</b>	<b>Social Studies</b>
<b>2:43</b>	<b>DISMISSAL</b>
<b>2:43</b>	<b>Bus Departure/ Car Riders &amp; Walkers Released</b>
<b>3:30</b>	<b>Office Closes</b>

## SY2024-2025 SCHOOL BELL SCHEDULE



### PRIMARY (1<sup>st</sup> Grade)

<b>7:30 – 8:15</b>	<b>Breakfast is Served</b>
<b>8:15 – 8:30</b>	<b>Classroom Morning Routine (Sanitizing Hands, Attendance, Recitation of Star Spangled Banner/Guam Hymn &amp; Pledge, Vision &amp; Mission Statement, SLOs, Announcements)</b>
<b>8:25</b>	<b>Students will be picked up by ESL/Special Programs Teachers (If applicable)</b>
<b>8:30 – 9:00</b>	<b>Writer's Window</b>
<b>9:00 – 9:45</b>	<b>Language</b>
<b>9:45 – 10:15</b>	<b>CHAMORU</b>
<b>10:15 – 10:45</b>	<b>Reading</b>
<b>10:45 – 11:30</b>	<b>LUNCH</b>
<b>11:30 – 12:00</b>	<b>Reading</b>
<b>12:00 – 1:00</b>	<b>Math</b>
<b>1:00 -1:45</b>	<b>Science</b>
<b>1:45 – 2:00</b>	<b>RECESS</b>
<b>2:00 – 2:43</b>	<b>Social Studies</b>
<b>2:43</b>	<b>DISMISSAL</b>
<b>2:43</b>	<b>Bus Departure/ Car Riders &amp; Walkers Released</b>
<b>3:30</b>	<b>Office Closes</b>

## SY2024-2025 SCHOOL BELL SCHEDULE



### PRIMARY (2<sup>nd</sup> Grade)

<b>7:30 – 8:15</b>	<b>Breakfast is Served</b>
<b>8:15 – 8:30</b>	<b>Classroom Morning Routine (Sanitizing Hands, Attendance, Recitation of Star Spangled Banner/Guam Hymn &amp; Pledge, Vision &amp; Mission Statement, SLOs, Announcements)</b>
<b>8:25</b>	<b>Students will be picked up by ESL/Special Programs Teachers (If applicable)</b>
<b>8:30 – 9:00</b>	<b>Writer's Window</b>
<b>9:00 – 9:30</b>	<b>Language</b>
<b>9:30 – 10:00</b>	<b>Reading</b>
<b>10:00 – 10:15</b>	<b>RECESS</b>
<b>10:30 – 11:00</b>	<b>CHAMORU</b>
<b>11:00 – 11:30</b>	<b>Reading</b>
<b>11:30 – 12:15</b>	<b>LUNCH</b>
<b>12:15 – 1:15</b>	<b>Math</b>
<b>1:15 – 2:00</b>	<b>Science</b>
<b>2:00 – 2:43</b>	<b>Social Studies</b>
<b>2:43</b>	<b>DISMISSAL</b>
<b>2:43</b>	<b>Bus Departure/ Car Riders &amp; Walkers Released</b>
<b>3:30</b>	<b>Office Closes</b>

## SY2024-2025 SCHOOL BELL SCHEDULE



### PRIMARY (3<sup>rd</sup> Grade)

7:30 – 8:15	Breakfast is Served
8:15 – 8:30	Classroom Morning Routine (Sanitizing Hands, Attendance, Recitation of Star Spangled Banner/Guam Hymn & Pledge, Vision & Mission Statement, SLOs, Announcements)
8:25	Students will be picked up by ESL/Special Programs Teachers (If applicable)
8:30 – 9:00	Writer's Window
9:00 – 9:30	Language
9:30 – 10:00	Reading
10:00 – 10:15	RECESS
10:15 – 10:45	Reading
10:45 – 11:15	Math
11:15 – 11:45	CHAMORU
11:45 – 12:30	LUNCH
12:30 – 1:00	Math
1:00 – 1:45	Science
1:45 – 2:43	Social Studies
2:43	DISMISSAL
2:43	Bus Departure/ Car Riders & Walkers Released
3:30	Office Closes

## SY2024-2025 SCHOOL BELL SCHEDULE



### INTERMEDIATE (4<sup>th</sup> Grade)

7:30 – 8:15	Breakfast is Served
8:15 – 8:30	Classroom Morning Routine (Sanitizing Hands, Attendance, Recitation of Star Spangled Banner/Guam Hymn & Pledge, Vision & Mission Statement, SLOs, Announcements)
8:25	Students will be picked up by ESL/Special Programs Teachers (If applicable)
8:30 – 9:00	Writer's Window
9:00 – 9:30	Language
9:30 – 10:15	Reading
10:15 – 10:30	RECESS
10:30 – 11:30	Math
11:30 – 12:30	Science
12:30 – 1:15	LUNCH
1:20 – 1:50	CHAMORU
1:50 – 2:43	Social Studies
2:43	DISMISSAL
2:43	Bus Departure/ Car Riders & Walkers Released
3:30	Office Closes

## SY2024-2025 SCHOOL BELL SCHEDULE



### INTERMEDIATE (5<sup>th</sup> Grade)

<b>7:30 – 8:15</b>	<b>Breakfast is Served</b>
<b>8:15 – 8:30</b>	<b>Classroom Morning Routine (Sanitizing Hands, Attendance, Recitation of Star Spangled Banner/Guam Hymn &amp; Pledge, Vision &amp; Mission Statement, SLOs, Announcements)</b>
<b>8:25</b>	<b>Students will be picked up by ESL/Special Programs Teachers (If applicable)</b>
<b>8:30 – 9:00</b>	<b>Writer's Window</b>
<b>9:00 – 9:30</b>	<b>Language</b>
<b>9:30 – 10:15</b>	<b>Reading</b>
<b>10:15 -10:30</b>	<b>RECESS</b>
<b>10:30 – 11:30</b>	<b>Math</b>
<b>11:30 – 12:10</b>	<b>Social Studies</b>
<b>12:10 – 12:40</b>	<b>CHAMORU</b>
<b>12:40 – 1:25</b>	<b>LUNCH</b>
<b>1:25 -2:43</b>	<b>Science</b>
<b>2:43</b>	<b>DISMISSAL</b>
<b>3:30</b>	<b>Bus Departure/ Car Riders &amp; Walkers Released</b>
	<b>Office Closes</b>

# SY 24-25 Bell Schedule



Agana Heights Elementary School



**Agana Heights Elementary School**  
 350 Joseph Cruz Avenue  
 Agana Heights, Guam 96910  
 671-477-8040/8340  
<https://sites.google.com/gdoe.net/ahes>



**K. Erik Swanson, Ph. D.**  
 Superintendent of Education

**Jolene Marie P. Cabrera, Ed. D.**  
 Principal

# BELL SCHEDULE

*Instructional time - 8:30am to 2:43pm on a regular school day*  
*\*Schedule subject to change based on District updates or School policies*

Class	Time	Grades
Gates Open	7:15 am	All Grades
Breakfast	7:15 am – 8:20 am	
Students Prepare for Class Entry	8:20 am – 8:25 am	
Teachers Receive Students	8:25 am	
Instructional Block 1	8:30 am – 10:33 am	
Recess	9:45 am – 10:00 am	Kinder/First 2 <sup>nd</sup> – 5 <sup>th</sup> Grade
	10:05 am – 10:20 am	
Instructional Block 2	10:00 am – 11:00 am	Kinder/First
	10:20 am – 11:50 am	2 <sup>nd</sup> /3 <sup>rd</sup> Grade
	10:20 am – 12:10 pm	4 <sup>th</sup> /5 <sup>th</sup> Grade
Staggered Lunch	11:00 am – 11:45 am	Kinder/First
	11:50 am – 12:35 pm	2 <sup>nd</sup> /3 <sup>rd</sup> Grade
	12:10 pm – 12:55 pm	4 <sup>th</sup> /5 <sup>th</sup> Grade
Instructional Block 3	11:45 am – 2:43 pm	Kinder/First
	12:35 pm – 2:43 pm	2 <sup>nd</sup> /3 <sup>rd</sup> Grade
	12:55 pm – 2:43 pm	4 <sup>th</sup> /5 <sup>th</sup> Grade
Staggered Dismissal	2:33 pm	Kinder/First
	2:38 pm	2 <sup>nd</sup> /3 <sup>rd</sup> Grade
	2:43 pm	4 <sup>th</sup> /5 <sup>th</sup> Grade

# SY 24-25 Bell Schedule



## Astumbo Elementary School



## *Home of the Butterflies*

**ASTUMBO ELEMENTARY  
SCHOOL YEAR 2024-2025  
BELL SCHEDULE**



- 7:00 AM Office Opens
- 7:15AM – 8:30 AM Gate Opens/Arrival of Students/Breakfast Line Opens  
**\*For Safety purposes, students shall not be dropped off on campus prior to 7:15am.**
- 7:30AM – 8:30 AM **EARLY MORNING TUTORING**
- 8:25AM Students are picked up by Homeroom Teachers from designated areas.
- 8:30AM – 10:00 AM **INSTRUCTION BEGINS**

### ***MORNING RECESS***

- 9:45am -10:00 am ***HS, Pre-K, Kinder, 1<sup>st</sup>, and 2<sup>nd</sup>***  
10:00am – 10:15am ***3<sup>rd</sup>, 4<sup>th</sup>, and 5<sup>th</sup> grade***

### **LUNCH PERIODS**

- 10:15 am – 11:00am ***HS & Pre-K Gate***  
11:00 am- 11:45 pm ***Kinder and 1<sup>st</sup> grade***  
11:45 pm -12:30 pm ***2<sup>nd</sup> grade and 3<sup>rd</sup> grade***  
12:30pm – 1:15pm ***4<sup>th</sup> grade and 5<sup>th</sup> grade***

### ***DISMISSAL***

***2:43 pm***

### ***SCHOOL OFFICE CLOSED***

***3:30PM***

#### **Dismissal Areas**

BUS – Front of Cafeteria Building  
Front Gate Walkers – I104  
Back gate walkers – E106  
Car riders – Front of Main Office

# SY 24-25 Bell Schedule



Baltazar P. Carbullido Elementary School



**K. Erik Swanson Ph.D.**  
Superintendent of Education

**DEPARTMENT OF EDUCATION**  
**B.P. CARBULLIDO ELEMENTARY SCHOOL**

#156 Canada-Toto Rd. Barrigada, GU 96913(Physical)  
500 Mariner Avenue Barrigada, Guam 96913-1608 (Mailing)  
Phone: (671)734-4341 | Email: BPCARBULLIDO@GMAIL.COM |  
<https://sites.google.com/view/bpces/home>



**B.P. CARBULLIDO**  
**ELEMENTARY SCHOOL**  
*Home of the Kiri's*  
**Lisa S. Cooper-Nurse, Ed.D**  
Principal  
**Carmen Rosario**  
Assistant Principal

*Accredited by the Western Association of Schools & Colleges*

**Instructional Bell Schedule**

**School Year 2024 - 2025**

7:15	Earliest Student Drop Off/Gates Open
7:30	Office Opens
7:30 – 8:10	Breakfast (late buses: Students will be allowed to eat breakfast)
8:30	First Instructional Block begins
10:00 – 10:15	Recess (Kinder, 1 <sup>st</sup> , 2 <sup>nd</sup> Grade)
10:15 – 10:30	Recess (3 <sup>rd</sup> , 4 <sup>th</sup> , 5 <sup>th</sup> Grade)
10:15, 10:30	Second Instructional Block begins
11:00 – 11:45	<b>LUNCH</b> Kinder and 3 <sup>rd</sup> Grade
11:15 – 12:00	<b>LUNCH</b> 1 <sup>st</sup> and 4 <sup>th</sup> Grade
11:45 – 12:30	<b>LUNCH</b> 2 <sup>nd</sup> and 5 <sup>th</sup> Grade
11:45, 12:00, 12:30	Third Instructional Block begins
2:43	Student Dismissal
3:00	Last student pick up time Office closes

**MISSION: To Educate, Nurture, Challenge, and Discipline**  
**All Students to be Responsible and Productive Citizens**

# SY 24-25 Bell Schedule



Capt. Henry B. Price Elementary School



Department of Education  
**CAPTAIN H. B. PRICE ELEMENTARY SCHOOL**

501 Mariner Ave,  
Barrigada, GU 96913-1608  
(671)734-2159



---

**BELL SCHEDULE**  
**SY: 2024 - 2025**

7:00 am	Staff Reporting Time
7:00 – 7:15 am	Staff Preparation
7:15 am	Bus Entry
7:20 am	Student Drop-off
7:15 – 8:25 am	Breakfast
8:25 am	Teacher Report Time
8:30 – 10:15/10:30 am	Classes Begin/First Instructional Block (Kinder – 5 <sup>th</sup> )
10:00 – 10:15 am	Primary Grades Recess (Kinder – 2 <sup>nd</sup> )
10:15 – 10:30 am	Intermediate Grades Recess (3 <sup>rd</sup> – 5 <sup>th</sup> )
10:15 am – Lunch	Primary Grades Second Instructional Block (Kinder – 2 <sup>nd</sup> )
10:30 am – Lunch	Intermediate Grades Second Instructional Block (3 <sup>rd</sup> – 5 <sup>th</sup> )
11:00 - 11:45 am	Kindergarten Lunch
11:15 - 12:00 pm	First Grade
11:30 - 12:15 pm	Second Grade
11:45 - 12:30 pm	Third Grade
12:00 - 12:45 pm	Fourth Grade
12:15 - 1:00 pm	Fifth Grade
Until 2:43 pm	Third Instructional Block
2:43 pm	Dismissal (Kinder – 5 <sup>th</sup> Grade)
2:53 pm	Teachers Dismissal
3:15 pm	Latest Student Pick-up*
3:30 pm	Office Closes
3:45 pm	Gates Locked

**Captain H.B. Price Mission Statement**

*"Captain H. B. Price Elementary School community promotes the development of the whole child by fostering a relevant and challenging curriculum that enables all students to become productive community member."*

# SY 24-25 Bell Schedule



Carlos L. Taitano Elementary School

# Carlos L. Taitano Elementary School

## BELL SCHEDULE

SY 2024-2025

Kindergarten – 1 <sup>st</sup> Grade Schedule		2 <sup>nd</sup> – 3 <sup>rd</sup> Grade Schedule		4 <sup>th</sup> – 5 <sup>th</sup> Grade Schedule	
7:15 a.m.	School Opens	7:15 a.m.	School Opens	7:15 a.m.	School Opens
7:30 a.m. – 8:25 a.m.	Breakfast	7:30 a.m. – 8:25 a.m.	Breakfast	7:30 a.m. – 8:25 a.m.	Breakfast
8:25 a.m. – 8:30 a.m.	Homeroom	8:25 a.m. – 8:30 a.m.	Homeroom	8:25 a.m. – 8:30 a.m.	Homeroom
8:30 a.m. – 10:45 a.m.	<u>1<sup>st</sup> Instructional Block</u> Reading/LArts	8:30 a.m. – 9:45 a.m.	<u>1<sup>st</sup> Instructional Block</u> Reading/LArts	8:30 a.m. – 10:15 a.m.	<u>1<sup>st</sup> Instructional Block</u> Reading/LArts
10:45 a.m. – 11:30 a.m.	Lunch	9:45 a.m. – 10:00 a.m.	Recess	10:15 a.m. – 10:30 a.m.	Recess
11:30 a.m. – 1:30 p.m.	<u>2<sup>nd</sup> Instructional Block</u> Math (1.15hrs), Science & Social Studies (45min)	10:00 a.m. – 11:40 a.m.	<u>2<sup>nd</sup> Instructional Block</u> LArts, Math	10:30 a.m. – 12:35 p.m.	<u>2<sup>nd</sup> Instructional Block</u> LArts, Math
1:30 p.m. – 1:45 p.m.	Recess	11:40 a.m. – 12:25 p.m.	Lunch	12:35 p.m. – 1:20 p.m.	Lunch
1:45 p.m. – 2:43 p.m.	<u>3<sup>rd</sup> Instructional Block</u> Science/Soc. Studies	12:25 p.m. – 2:43 p.m.	<u>3<sup>rd</sup> Instructional Block</u> Math, Science, Social Studies	1:20 p.m. – 2:43 p.m.	<u>3<sup>rd</sup> Instructional Block</u> Science, Social Studies

# SY 24-25 Bell Schedule



Chief Brodie Memorial Elementary School



CBMES

## BELL SCHEDULE 2024-2025

Kinder – 2 <sup>nd</sup> Grade				
Time		Kindergarten	1 <sup>st</sup> Grade	2 <sup>nd</sup> Grade
8:15-8:25		Morning Assembly & Teachers pick up students		
8:30-8:40		Read Aloud: HMH Journeys		PARTNER READING
8:40-8:50		Whole Group Reading Instruction		Journeys “Target Vocabulary”
8:50-10:10		READING MASTERY LESSONS (Small Groups) No more than 3 reading groups		READING WORKSHOP
				(10-mins) Mini-Lesson – Whole Group
				(45-mins) Guided Practice & Independent Practice – Whole Group/Small Group/ 1:1
				(10-mins) Student Debrief (Whole Group)
				(15-mins) W.I.N. Time “What I Need” - Intervention/Enrichment/Practice
10:10-10:25		Recess		
10:25 – 11:35		MATH WORKSHOP **may be split to accommodate special services		
10:25 - 10:35		(10-mins) Warm Up: Math Facts		
10:35 - 10:50		(15-mins) Mini-Lesson: Modeling, Guided Practice, Conversation		
10:50 – 11:05		(15-mins) Active Engagement “Try it Out”		
11:05 - 11:30		(25-mins) Guided Math: Centers and/or Independent Practice		
11:30 - 11:35		(5-mins) Closing		
11:35 – 12:20		Lunch		
12:20-1:50		HMH Journeys “Language Arts” Spelling, Grammar Writing		
1:50 – 2:43		HMH Journeys “Cross-Curricular Connections” Workshops Social Studies/Science/Health/Art/P.E.		
		Mini-Lesson		
		Guided Practice & Independent Practice		
		Student Debrief		
2:43		Student Dismissal		



## BELL SCHEDULE 2024-2025

3 <sup>rd</sup> – 5 <sup>th</sup> Grade		
8:15-8:25		Morning Assembly & Teachers pick up students
8:30-8:40		<b>PARTNER READING</b>
8:40-8:50		<b>Target Vocabulary from Journeys /</b>
8:50-10:00		<b>READING WORKSHOP</b>
8:50 – 9:00		(10-mins) Mini-Lesson – Whole Group
9:00 – 9:45		(45-mins) Guided Practice & Independent Practice – Whole Group/Small Group/ 1:1
9:45 – 9:55		(10-mins) Student Debrief (Whole Group)
9:55 – 10:10		(15-mins) W.I.N. Time “What I Need” - Intervention/Enrichment/Practice
<b>10:10-10:25</b>		<b>Recess</b>
10:25 – 11:25		<b>MATH WORKSHOP **may be split to accommodate special services</b>
10:15 - 10:20		(5-mins) Warm Up: <b>Math Facts</b> and/or Math Review of previous skill
10:20 - 10:35		(15-mins) Mini-Lesson: Modeling, Guided Practice, Conversation
10:35 – 10:50		(15-mins) Active Engagement “Try it Out”
10:50 - 11:15		(25-mins) Guided Math: Centers and/or Independent Practice
11:15 - 11:35		(5-mins) Closing
11:35-12:25		Houghton Mifflin Harcourt Journeys “ <b>Cross-Curricular Connections</b> ” Workshop for L.A. ( <i>Spelling, Grammar, Writing</i> ) Social Studies/Science/Health/Art/P.E.
<b>12:25 – 1:10</b>		<b>Lunch</b>
1:10 – 2:43		Houghton Mifflin Harcourt Journeys “ <b>Cross-Curricular Connections</b> ” Workshop
<b>2:43</b>		<b>Student Dismissal</b>
2:58		Teacher Dismissal
3:00		Office Closed

\*Schedule is subject to change\*

**GUAM DEPARTMENT OF EDUCATION  
DANIEL L. PEREZ ELEMENTARY SCHOOL  
BELL SCHEDULE SY 2024-2025**

**SCHOOL BELL SCHEDULE**

7:15 a.m.	School and Main Office Opens
7:30 a.m. – 8:20 a.m.	Breakfast
8:20 a.m. – 8:25 a.m.	Teachers to Bring Students into the Classroom
8:30 a.m.	Instructional Time Begins

**1<sup>st</sup> Instructional Block**

**Recess** for Grades 2<sup>nd</sup> – 5<sup>th</sup> – 10:00 a.m. to 10:15 a.m.

**2<sup>nd</sup> Instructional Block**

10:30 a.m. – 11:15 a.m.	Lunch (Kinder/1 <sup>st</sup> Grade)
11:15 a.m. – 12:00 p.m.	Lunch (2 <sup>nd</sup> /3 <sup>rd</sup> Grade)
12:00 p.m. – 12:45 p.m.	Lunch 4 <sup>th</sup> /5 <sup>th</sup> Grade)

**Recess** for Grades Kinder/1<sup>st</sup> – 1:00 p.m. – 1:15 p.m.

**3<sup>rd</sup> Instructional Block**

2:43 p.m.	Dismissal
2:55 p.m.	Bus Dismissal

# SY 24-25 Bell Schedule



D.L. Perez Elementary School

# SY 24-25 Bell Schedule



## Finegayan Elementary School

# **FINEGAYAN ELEMENTARY SCHOOL**

**School Year 2024-2025**

## **BELL SCHEDULE**



<b>7:15am</b>	<b><i>Main Gate opens for busses</i></b>
<b>7:30am</b>	<b><i>Main Gate opens for car riders</i></b>
<b>7:30am-7:45am</b>	<b><i>Side gates open for walkers (Kasperbauer)</i></b>
<b>7:50am-8:05am</b>	<b><i>Side gates open for walkers (FernTerrace)</i></b>
<b>7:20am-8:20am</b>	<b><i>Breakfast service</i></b>
	<b><i>Early Bird Tutoring Program</i></b>
<b>8:20am</b>	<b><i>Warning Bell</i></b>
<b>8:25am-8:30am</b>	<b><i>Homeroom</i></b>
<b>8:30am</b>	<b>INSTRUCTIONAL BLOCK BEGINS</b>
<b>9:45am-10:00am</b>	<b><i>Recess-HS, Pre-K, Kinder, 1<sup>st</sup>, 2<sup>nd</sup> grade</i></b>
<b>10:15am- 10:30am</b>	<b><i>Recess-3<sup>rd</sup>, 4<sup>th</sup>, 5<sup>th</sup> grade</i></b>
<b>10:40am-11:25am</b>	<b><i>Lunch-HS, Pre-K, Kinder</i></b>
<b>11:00am- 11:45am</b>	<b><i>Lunch-1<sup>st</sup> grade</i></b>
<b>11:20am- 12:05pm</b>	<b><i>Lunch-2<sup>nd</sup> grade</i></b>
<b>11:40pm -12:25pm</b>	<b><i>Lunch-3<sup>rd</sup> grade</i></b>
<b>12:00pm-12:45pm</b>	<b><i>Lunch-4<sup>th</sup> grade</i></b>
<b>12:20pm-1:05pm</b>	<b><i>Lunch-5<sup>th</sup> grade</i></b>
<b>2:43pm</b>	<b>INSTRUCTIONAL BLOCK ENDS</b>
<b><i>Staggered Dismissal Procedure begins</i></b>	
<b>2:43pm</b>	<b><i>HS &amp; Pre-K, &amp; Kinder</i></b>
<b>2:46pm</b>	<b><i>1<sup>st</sup> grade &amp; 2<sup>nd</sup> grade</i></b>
<b>2:50pm</b>	<b><i>3<sup>rd</sup> grade, 4<sup>th</sup> grade &amp; 5<sup>th</sup> grade</i></b>
<b>2:53pm</b>	<b><i>Dismissal Clearance (Busses, Walkers, &amp; Car drive-up Pick-ups)</i></b>
<b><i>ASPIRE begins at 3:00pm and ends at 5:00pm</i></b>	

Updated 07.01.2024  
mdcgarcia

# SY 24-25 Bell Schedule



Harry S. Truman Elementary School

# Harry S Truman Elementary School

## *SY 24-25 Instructional Bell Schedule*

<b>7:30am</b>	Gates Open
<b>7:30am-8:25am</b>	Breakfast
<b>8:15am-8:25am</b>	Teachers pickup students from holding areas
<b>8:30am</b>	Class Begins
<b>8:30am-9:30am</b>	1st Instructional block (ALL)
<b>9:30am-10:30am</b>	2nd Instructional block (ALL)
<b>10:30am-10:45am</b>	Recess (All grade levels)
<b>10:45am-11:15am</b>	Instructional Block (Kinder/1st)
<b>10:45am-11:30am</b>	Instructional Block (2nd/3rd)
<b>10:45am-11:45am</b>	Instructional Block (4th/5th)
<b>11:15am - 12:00pm</b> <b>11:30am-12:15am</b>	Lunch (Pre-Gate, Headstart, Kinder & 1 <sup>st</sup> Grade) Lunch (2 <sup>nd</sup> , 3 <sup>rd</sup> , 4 <sup>th</sup> & 5 <sup>th</sup> Grade)
<b>12:05pm-2:43pm</b>	Instructional Block (Kinder & 1 <sup>st</sup> Grade)
<b>12:15pm-2:43pm</b>	Instructional Block (2 <sup>nd</sup> , 3 <sup>rd</sup> , 4 <sup>th</sup> & 5 <sup>th</sup> Grade)
<b>2:43pm</b>	Dismissal



# SY 24-25 Bell Schedule



## Inalahan Elementary School

# Inalahan Elementary School

## SY 2023-2024 Block Schedule

	K		1st		2nd		3rd		4th		5th				
	M	T	W	TH	F	M	T	W	TH	F	M	T	W	TH	F
7:15 - 8:15	Breakfast														
8:15 - 8:30	Homeroom														
8:30 - 8:45	Cham 8:30 - 8:50														
8:45 - 9:00	Cham 9:00 - 9:20														
9:00 - 9:15	Math														
9:15 - 9:30															
9:30 - 9:45	Cham 9:30 - 9:50														
9:45 - 10:00	Reading														
10:00 - 10:15															
10:15 - 10:30															
10:30 - 10:45	Recess														
10:45 - 11:00	Cham 10:45 - 11:05														
11:00 - 11:15	Language Arts														
11:15 - 11:30															
11:30 - 11:45															
11:45 - 12:00	Lunch K - 2nd		3rd - 5th Lunch resess												
12:00 - 12:15	Lunch recess k-2nd		Lunch/Recess 3rd - 5th												
12:15 - 12:30															
12:30 - 12:45	Science					Cham 12:30 - 1:00					Science 12:30 - 1:00				
12:45 - 1:00						Science 1:00 - 1:30					Social Studies 1:00 - 1:30				
1:00 - 1:15						Social Studies 1:30 - 2:00					Cham 1:30 - 2:00				
1:15 - 1:30															
1:30 - 1:45															
1:45 - 2:00															
2:00 - 2:15	Intervention		Intervention		Intervention		Intervention		Intervention		Intervention		Intervention		
2:15 - 2:43	Monday Reading		Tuesday Math		Monday Reading		Thursday Math		Monday Reading		Monday Reading		Monday Reading		

# SY 24-25 Bell Schedule



Juan M. Guerrero Elementary School



# School Year 2024-2025

## BELL SCHEDULE



7:15am	Gates Open
7:15am – 8:15am	Breakfast Served
8:15am	Warning Bell
8:20am– 8:30am	Homeroom
8:30am	Instructional Block
10:00am – 10:15am	Recess Primary (K, 1 <sup>st</sup> , 2 <sup>nd</sup> )
10:30am - 10:45am	Recess - Intermediate (3 <sup>rd</sup> , 4 <sup>th</sup> , 5 <sup>th</sup> )
11:00am – 11:45am	Lunch A (K, 1 <sup>st</sup> ) Cafeteria
11:45am – 12:30pm	Lunch B (2 <sup>nd</sup> ) Cafeteria
	Lunch B (3 <sup>rd</sup> ) Cafeteria
12:30pm – 1:15pm	Lunch C (4 <sup>th</sup> & 5 <sup>th</sup> ) Cafeteria
1:15pm – 2:43pm	Instructional Block
2:43pm	End of the School Day

### JMGES EVACUATION ROUTE

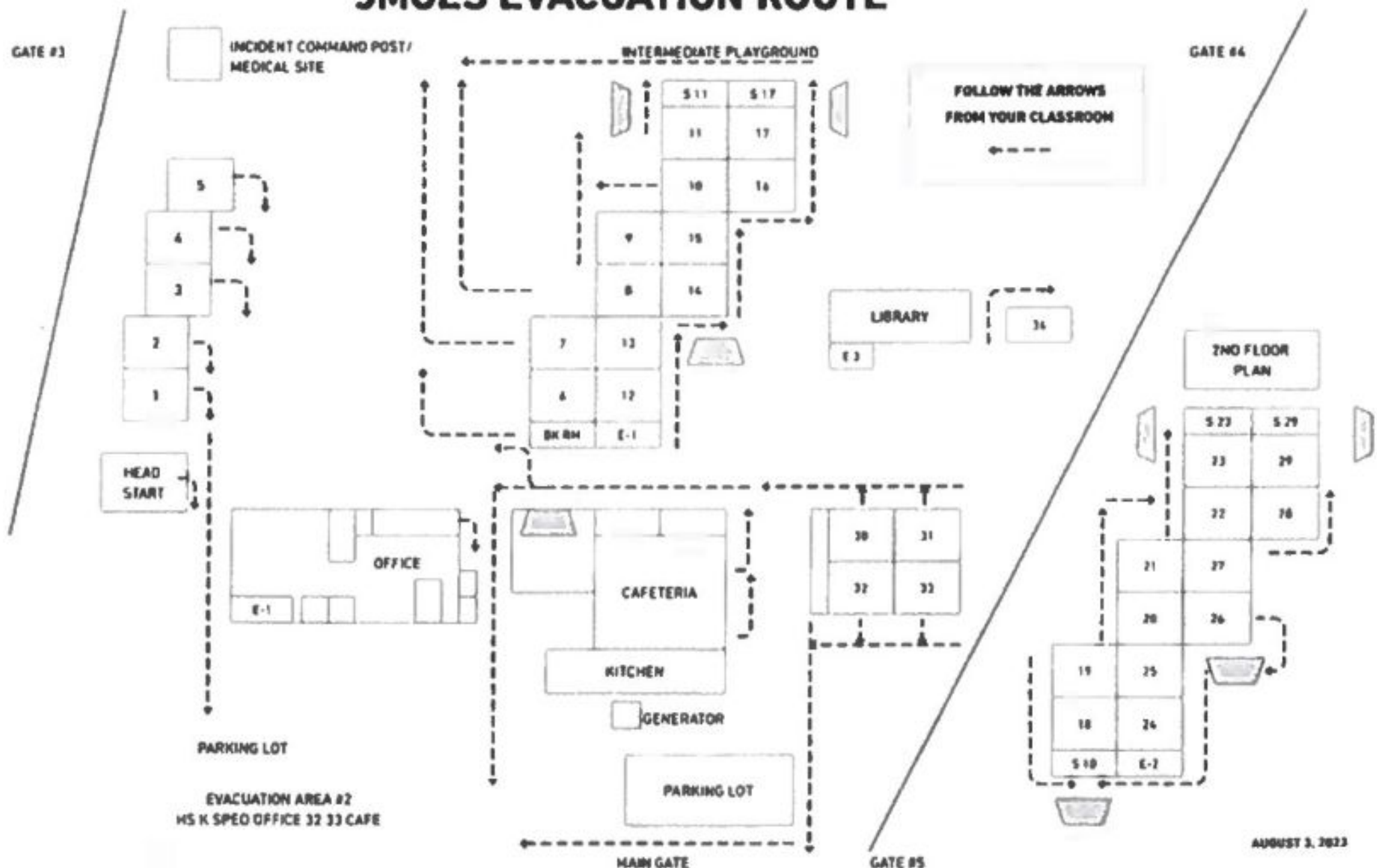

# SY 24-25 Bell Schedule



Juan Q. San Miguel Elementary School



**K. Erik Swanson, Ph.D.**  
Superintendent of Education

## **DEPARTMENT OF EDUCATION**

**JUAN Q. SAN MIGUEL ELEMENTARY**

**Home of the Eagles**

491 Clara Road – Toto, Guam 96910

Telephone: (671) 477-9370

Website: <https://jqsm671.weebly.com>

Email: [jqsmes-office@gdoe.net](mailto:jqsmes-office@gdoe.net)

WhatsApp: (671) 300-4462

Accredited by  
Association of Schools and Colleges



**Elias T. Taisipic**  
Acting Principal

## **SY2024-2025 BELL SCHEDULE**

7:00	Gate Open
7:15	Bus Drop Off/Car riders drop off
7:15 – 8:25	Breakfast
8:25 – 8:30	Transition to Classrooms
8:30 – 10:00	1st Instructional Block (Pre-K - 5th)
10:00 – 10:15	RECESS (All Grades)
10:15 – 11:30	2 <sup>nd</sup> Instructional Block (Pre-K - 2nd)
10:15 – 12:00	2 <sup>nd</sup> Instructional Block (3rd - 5th)
11:30 – 12:15	LUNCH (Primary)
12:00 – 12:45	LUNCH (Intermediate)
12:15 – 2:43	3 <sup>rd</sup> Instructional Block (Pre-K - 2nd)
12:45 – 2:43	3 <sup>rd</sup> Instructional Block (3rd-5th)
2:43	STUDENT DISMISSAL
2:48	TEACHER DISMISSAL
2:43 – 5:00	AFTER SCHOOL PROGRAM

# SY 24-25 Bell Schedule



## Liguan Elementary School

# Liguan Elementary School

## Master Schedule

7:15 – 8:15 am	Morning arrival / breakfast serving
8:25 am	Teachers pick up students
8:30am	Morning Routine (Mondays) / Announcements
	<b>Instructional Block I</b>
8:45-9:15am	5 <sup>th</sup> grade Chamorro *Prep
9:30-10:00am	4 <sup>th</sup> grade Chamorro *Prep
9:45-10:00am	<b>RECESS (K-2)</b>
10:15-10:30am	<b>RECESS (3-5)</b>
10:40- 11:10am	3 <sup>rd</sup> grade Chamorro *Prep
	<b>Instructional Block II</b>
11:15-12:00pm	<b>LUNCH (K-2) &amp; Chamorro teachers</b>
12:15-1:00pm	<b>LUNCH (3-5)</b>
	<b>Instructional Block III</b>
12:10- 12:40pm	1 <sup>st</sup> grade Chamorro *Prep
12:45-1:15pm	Kinder Chamorro *Prep
1:20- 1:50pm	2 <sup>nd</sup> grade Chamorro *Prep
2:00-2:25pm	Homeroom/ Intervention Block
2:25-2:35pm	Sanitization Block
2:35pm	Dismissal C wing (K-2)
2:40pm	Dismissal A wing (3-5)
2:43pm	<b>DISMISSAL (Bus, Walkers, &amp; Car Riders)</b>

\*Special Programs will be infused into the schedule\*

Acknowledged by: J. Punongbayan

*LES Mission Statement: To educate, nurture, and prepare students to be productive global citizens*

# SY 24-25 Bell Schedule



Lydon B. Johnson Elementary School

# LYNDON B. JOHNSON ELEMENTARY SCHOOL

SY 2024 - 2025

## Bell Schedule



**7:15 a.m.**

Arrival of Students

**FOR SAFETY PURPOSES, STUDENTS MUST NOT BE ON CAMPUS PRIOR TO 7:15 A.M.**

**8:15 a.m.**

Teacher Reporting Time & Class Preparations

**8:30 a.m.**

Instruction Begins

### **MORNING RECESS TIMES**

**9:45-10:00 a.m.**

Pre-Kindergarten Recess

**10:00-10:15 a.m.**

Kindergarten Morning Recess

**10:15-10:30 a.m.**

1<sup>st</sup> Grade Morning Recess

### **LUNCH PERIODS**

**10:45 a.m.-11:30 a.m.** F1, F2, TK2, F3

**11:15 a.m.-12:00 p.m.** K1, K2, K3, K4, K5

**11:45 a.m.-12:30 p.m.** F6, F7

**12:15 p.m.-1:00 p.m.** F4, F8, F9

**2:43 p.m.**

Dismissal

**3:30 p.m.**

School Office Closed

**5:00 p.m.**

End of ASPIRE

# SY 24-25 Bell Schedule



Machananao Elementary School

# MACHANANAO ELEMENTARY SCHOOL

## DAILY BELL SCHEDULE

School Year 2024-2025

7:15 a.m.	School Opens
7:30 a.m. - 8:15 a.m.	Breakfast
8:15 a.m. - 8:30 a.m.	Homeroom
8:30 a.m. - 9:45 a.m.	Language Arts (Reading, Phonemic Awareness, Writing, Written and Oral Language Conventions, Spelling, Penmanship, Listening, Speaking and Comprehension)
9:30 a.m. - 9:45 a.m.	Kindergarten, 1st, and 2nd Grade Morning Recess
9:45 a.m. - 10:00 a.m.	3rd, 4th and 5th Grade Morning Recess
10:00 a.m. - 11:00 a.m.	Mathematics Instructional Block
11:00 a.m. - 12:45 p.m.	Content Instructional Block
10:30 a.m. - 11:15 a.m.	GATE Pre-K and Primary Lunch/Lunch Recess
11:15 a.m. - 12:15 p.m.	Intermediate Lunch/Lunch Recess
12:00 p.m. - 12:45 p.m.	4 <sup>th</sup> and 5 <sup>th</sup> Grade Lunch/Lunch Recess
12:45 p.m. - 1:35 p.m.	Language Arts (Reading, Phonemic Awareness, Writing, Written and Oral Language Conventions, Spelling, Penmanship, Listening, Speaking and Comprehension)
1:35 p.m. - 2:43 p.m.	Content Instructional Block
2:43 p.m.	Dismissal
2:58 p.m.	End of Teacher Duty Day
3:45 p.m.	School Office Closed



# SY 24-25 Bell Schedule



Manuel U. Lujan Elementary School



## GUAM DEPARTMENT OF EDUCATION

### M.U. Lujan Elementary School

www.mulujanelementaryschool.weebly.com  
501 Mariner Avenue, Barrigada Guam 96913-1608  
Telephone: (671)789-1535



**K. ERIK SWANSON, PH. D**  
Superintendent of Education

**Natasha A. Dela Cruz, Principal**  
**Silvino U. Quinene, Assistant Principal**

### **MULES Bell Schedule SY 2024-2025**

7:15 am	Gates Open
7:15 am – 8:25 am	Breakfast & Student Arrival
8:25 am	Warning Bell
8:30 am	Instructional Day Begins
10:00 am - 10:15 am	Recess 2 <sup>nd</sup> & 3 <sup>rd</sup> Grade
10:30 am – 10:45 am	Recess 4 <sup>th</sup> & 5 <sup>th</sup> Grade
10:45 am – 11:30 am	Lunch Kinder & 1 <sup>st</sup> Grade
12:00 pm – 12:45 pm	Lunch 2 <sup>nd</sup> & 3 <sup>rd</sup> Grade
12:45 pm – 1:30 pm	Lunch 4 <sup>th</sup> & 5 <sup>th</sup> Grade
1:30 pm – 1:45 pm	Kinder & 1 <sup>st</sup> Grade Recess
2:43 pm	Instructional Day Ends Dismissal

# SY 24-25 Bell Schedule



Marcial A. Sablan Elementary School



**K. Erik Swanson, Ph.D.**  
Superintendent of Education

## DEPARTMENT OF EDUCATION

### Marcial A. Sablan Elementary School

Physical Address: 144 San Vicente Avenue, Agat, Guam 96928

Mailing Address: 501 Mariner Avenue, Barrigada, Guam 96913

Telephone: (671) 565-2238/2946

*"Every Student: Responsible, Respectful, and Ready for Life"*



**Neldie Pendon-Limtiaco**  
Acting Principal

## SCHOOL YEAR 2024-2025 BELL SCHEDULE

6:30 AM	Gate Opens
7:15 AM	Gate Opens for Buses and Student Drop Off
7:20 AM	Breakfast Served in the Cafeteria
8:25 AM	Students Picked Up to Enter Classroom
8:30 AM	First Instructional Block
10:00 - 10:15 AM	Primary Recess (Kindergarten to 2 <sup>nd</sup> Grades)
10:30 - 10:45 AM	Intermediate Recess (3 <sup>rd</sup> to 5 <sup>th</sup> Grades)
10:15 AM	Primary Second Instructional Block
10:45 AM	Intermediate Second Instructional Block
11:15 - 12:00 PM	Primary Lunch (Kindergarten to 2 <sup>nd</sup> Grades)
12:00 - 12:45 PM	Intermediate Lunch (3 <sup>rd</sup> to 5 <sup>th</sup> Grades)
12:00 PM	Primary Third Instructional Block
12:45 PM	Intermediate Third Instructional Block
2:43 PM	Instructional Day Ends
3:30 PM	Gate Closes

*"All Students at Marcial A. Sablan will learn to achieve success in life"*

SELF-DISCIPLINED TEAM WORKERS ACADEMICALLY ACCOUNTABLE RESPONSIBLE LEADERS SELF-ASSURED CITIZENS

# SY 24-25 Bell Schedule



Maria A. Ulloa Elementary School

# SY 2024-2025 BELL SCHEDULE

Time	Kinder	1 <sup>st</sup> Grade	2 <sup>nd</sup> Grade	3 <sup>rd</sup> Grade	4 <sup>th</sup> Grade	5 <sup>th</sup> Grade	GATE	SPED	LIBRARY	ESL
8:15-8:30	HOMEROOM	HOMEROOM	HOMEROOM	HOMEROOM	HOMEROOM	HOMEROOM	HOMEROOM	HOMEROOM		HOMEROOM
8:30-8:45									Library OPEN for stakeholders usage (8:15-9:00) 45 minutes	Reading/ELA (8:30-9:30) 60 minutes CRUZ/QUAMBAO
8:45-9:00							Curriculum / Office Outreach (8:30-9:45) 75 minutes MON-WED			
9:00-9:15	Reading/ELA (8:30-9:30) 60 minutes	Reading/ELA (8:30-10:00) 90 minutes	Reading/ELA (8:30-10:00) 90 minutes	Reading/ELA (8:30-9:45) 75 minutes	Reading/ELA (8:30-9:45) 75 minutes	Reading/ELA (8:30-9:45) 75 minutes	Curriculum / Office Outreach (8:30-9:30) 60 minutes THU-FRI	Classroom Time (8:30-9:45) 75 minutes Resource Room Direct Services/ Instruction	Library admin duties MON ONLY (9:00-9:30) 30 minutes	Reading/ELA (8:30-9:45) 75 minutes FERNANDO
9:15-9:30									Class Time TUE-FRI Rooms 24, HS1, HS2, 30	
9:30-9:45	RECESS (9:30-9:45) 15 minutes	RECESS (9:30-9:45) 15 minutes	RECESS (9:30-9:45) 15 minutes				RECESS (9:30-9:45) 15 minutes		RECESS OPEN for student use (9:30-9:45) 15 minutes	RECESS (9:30-9:45) 15 minutes
9:45-10:00			Reading/ELA (9:45-10:00) 15 min	RECESS (9:45-10:00) 15 minutes	RECESS (9:45-10:00) 15 minutes	RECESS (9:45-10:00) 15 minutes	RECESS (9:45-10:00) 15 minutes	RECESS (9:45-10:00) 15 minutes	RECESS OPEN for student use (9:45-10:00) 15 minutes	RECESS (9:45-10:00) 15 minutes
10:00-10:15	Reading/ELA (9:45-10:30) 45 minutes	Reading/ELA (9:45-10:30) 45 minutes	Chamoru (10:00-10:45) 45 minutes MON/WED	Reading/ELA (10:00-10:45) 45 minutes MON/WED		Reading/ELA (10:00-11:00) 60 minutes TUE/TH	Classroom Time 3rd Grade MON 1 <sup>st</sup> /2 <sup>nd</sup> Grade THU (10:00-11:15) 75 minutes		Library duties MON ONLY (10:00-10:30) 30 minutes	
10:15-10:30			Reading/ELA Interventions (10:00-10:45) 45 min TUE/TH	Chamoru (10:00-10:45) 45 minutes TUE/TH	Math (10:00-11:00) 60 min	Math (10:00-11:00) 60 minutes MON/WED	LUNCH (11:15-12:00) MON/THU ONLY		Class Time TUE-FRI RMs 14, 15, 16, 17	Reading/ELA (9:45-10:30) 45 minutes QUAMBAO
10:30-10:45							Classroom Time 3rd Grade MON 1 <sup>st</sup> /2 <sup>nd</sup> Grade THU (12:00-12:45) 45 minutes		Library duties MON ONLY (10:30-11:00) 30 minutes	LUNCH (10:30-11:15) QUAMBAO ONLY
10:45-11:00	LUNCH (10:30-11:15) 45 minutes	LUNCH (10:30-11:15) 45 minutes	Reading/ELA (10:45-11:15) 30 minutes	Reading/ELA (10:45-11:15) 30 minutes			Classroom Time 4 <sup>th</sup> Grade TUE 5 <sup>th</sup> Grade WED (10:00-12:00) 120 minutes		Class Time TUE-THU RMs 1, 22, 3	Classroom Time READING/ELA (9:45-11:15) FERNANDO M/W CRUZ T/TH
11:00-11:15									Library duties MON ONLY (11:00-11:30) 30 minutes	
11:15-11:30					Chamoru (11:00-12:00) 60 minutes MON/WED	Reading/ELA (11:00-12:00) 60 minutes MON/WED	LUNCH (12:00-12:45) TUE/WED ONLY		Class Time TUE-THU RMs 31, 103, 33	LUNCH (11:15-12:00) CRUZ/ FERNANDO ONLY
11:30-11:45	Math (11:15-12:15) 60 minutes	Math (11:15-12:15) 60 minutes	LUNCH (11:15-12:00) 45 minutes	LUNCH (11:15-12:00) 45 minutes	Reading/ELA (11:00-12:00) 60 minutes TUE/TH	Chamoru (11:00-12:00) 60 minutes TUE/TH	Classroom Time Kinder/ Screening/ Testing FRI (9:45-10:30) 45 minutes	Classroom Time (10:00-1:30) 210 minutes Resource Room Direct Services/ Instruction	Library duties MON ONLY (11:30-12:00) 30 minutes	
11:45-12:00									Class Time TUE-THU RMs 32, 104, 34	
12:00-12:15							LUNCH (10:30-11:15) Friday ONLY			
12:15-12:30	Content (12:15-12:45) 30 minutes	Content (12:15-12:45) 30 minutes	Math (12:00-1:00) 60 minutes	Math (12:00-1:00) 60 minutes	LUNCH (12:00-12:45) 45 minutes	LUNCH (12:00-12:45) 45 minutes	Classroom Time Kinder/ Screening/ Testing FRI (11:15-12:45) 90 minutes		LUNCH (12:00-1:00) 60 minutes	Testing/Filing OR OPT (12:00-12:45) 45 minutes ALL TEACHERS
12:30-12:45										
12:45-1:00	Chamoru (12:45-1:30) 45 minutes MON/WED	Content (12:45-1:30) 45 minutes MON/WED					Classroom Time 3 <sup>rd</sup> Grade MON 4 <sup>th</sup> Grade TUE 5 <sup>th</sup> Grade WED 1 <sup>st</sup> /2 <sup>nd</sup> Grade THU Kinder FRI (12:45-1:45) 45-60 minutes		Library duties MON ONLY (1:00-1:30) 30 minutes	Intervention (12:45-1:30) 45 minutes FERNANDO/ QUAMBAO
1:00-1:15	Content (12:45-1:30) 45 minutes TUE/TH	Chamoru (12:45-1:30) 45 minutes TUE/TH			Reading/ELA Intervention (12:45-1:30) 45 minutes	Math (12:45-1:45) 60 minutes TUE/TH	Content (12:45-1:45) 60 minutes MON/WED		Class Time TUE-THU RMs 12, 203, 23, 35	Coordinator Duties (12:45-1:30) 45 minutes CRUZ
1:15-1:30										
1:30-1:45			Content (1:00-2:30) 90 minutes		Content (1:00-2:10) 70 minutes				Library duties MON ONLY (1:30-2:00) 30 minutes	
1:45-2:00	Content con't (1:30-2:30) 60 minutes	Content con't (1:30-2:30) 60 minutes			Content con't (1:30-2:30) 45 minutes		GATE Planning & Preparation OR Special Areas OPT (1:45-2:30) 45-60 minutes	LUNCH (1:30-2:15) 45 minutes	Class Time TUE-THU RMs 2, 204, 4, 25	Testing/Filing con't (1:30-2:30) 60 minutes ALL TEACHERS
2:00-2:15									Library duties MON ONLY (2:00-2:30) 30 minutes	
2:15-2:30				Interventions (2:10-2:20) 10 minutes				SpEd Document Prep (2:15-2:43) 28 minutes	Class Time TUE-THU RMs 9, 10, 11	
2:30-2:43	Prepare for Dismissal (2:30-2:43) 13 minutes	Prepare for Dismissal (2:30-2:43) 13 minutes	Prepare for Dismissal (2:30-2:43) 13 minutes	Prepare for Dismissal (2:30-2:43) 13 minutes	Prepare for Dismissal (2:30-2:43) 13 minutes	Prepare for Dismissal (2:30-2:43) 13 minutes	Prepare for Dismissal (2:30-2:43) 13 minutes		Prepare for Dismissal (2:30-2:43) 13 minutes	Prepare for Dismissal (2:30-2:43) 13 minutes
2:43										

# SY 24-25 Bell Schedule



Merizo Martyrs Memorial School



# Merizo Martyrs' Memorial School

## Bell Schedule

7:30 am	Gate/Office Opens
7:30-8:25	Breakfast
8:25-8:30	Flag Ceremony
8:30-10:00	1 <sup>st</sup> Instructional Block -ELA
10:00-10:15	Recess
10:15-10:45	Continuation of 1 <sup>st</sup> Instructional Block
10:45-11:45	2 <sup>nd</sup> Instructional Block -Math (K-1 <sup>st</sup> )
10:45-12:00	2 <sup>nd</sup> Instructional Block -Math (2 <sup>nd</sup> -3 <sup>rd</sup> )
10:45-12:15	2 <sup>nd</sup> Instructional Block -Math (4 <sup>th</sup> -5 <sup>th</sup> )
11:45-12:30	Lunch (K-1 <sup>st</sup> )
12:00-12:45	Lunch (2 <sup>nd</sup> -3 <sup>rd</sup> )
12:15-1:00	Lunch (4 <sup>th</sup> -5 <sup>th</sup> )
12:30-2:43	3 <sup>rd</sup> Instructional Block -Integration (K-1 <sup>st</sup> )
12:45-2:43	3 <sup>rd</sup> Instructional Block -Integration (2 <sup>nd</sup> -3 <sup>rd</sup> )
1:00-2:43	3 <sup>rd</sup> Instructional Block -Integration (4 <sup>th</sup> -5 <sup>th</sup> )
2:43 pm	Dismissal Bell
3:00 pm	Office Closes
3:30 pm	Gate Closes

# SY 24-25 Bell Schedule



Ordot Chalan Pago Elementary School



# ORDOT-CHALAN PAGO ELEMENTARY

## SCHOOL YEAR 2024 - 2025

### DAILY BELL SCHEDULE

7:15 a.m.	Gates open for buses and car riders
7:15 – 8:15 a.m.	Breakfast served
8:15 a.m.	First Bell
8:30 – 8:45 a.m.	Homeroom / Circle Time
8:45 – 11:00 a.m.	Instructional Block I (K – 2 <sup>nd</sup> )
8:45 – 10:00 a.m.	Instructional Block I (3 <sup>rd</sup> – 5 <sup>th</sup> )
10:00 – 10:15 a.m.	<b>Recess 3<sup>rd</sup> - 5<sup>th</sup></b>
10:15 – 11:30 a.m.	Instructional Block II (3 <sup>rd</sup> – 5 <sup>th</sup> )
11:00 – 11:45 a.m.	<b>Lunch Period (K – 2<sup>nd</sup> )</b>
11:30 – 12:15 p.m.	<b>Lunch Period (3<sup>rd</sup> – 5<sup>th</sup>)</b>
11:45 – 1:15 p.m.	Instructional Block II (K – 2 <sup>nd</sup> )
1:15 – 1:30 p.m.	<b>Recess K – 2<sup>nd</sup></b>
12:15 – 2:43 p.m.	Instructional Block III (3 <sup>rd</sup> – 5 <sup>th</sup> )
1:30 – 2:43 p.m.	Instructional Block III (K – 1 <sup>st</sup> )
2:43 p.m.	Dismissal K - 5 <sup>th</sup>

# SY 24-25 Bell Schedule



Pedro C. Lujan Elementary School



DEPARTMENT OF EDUCATION  
**PEDRO C. LUJAN ELEMENTARY SCHOOL**  
 387 East Route 8 Radio Barrigada  
 Barrigada, Guam 96921  
 Telephone: (671) 734-3971



**K. Erik Swanson, Ph.D.**  
 Superintendent of Education

**Beth N .Perez**  
 Principal

7:15 a.m. 7:30 a.m. – 8:25 a.m.		Gates Open for Student Drop Off Student Breakfast	
<b>Primary:K-2<sup>nd</sup> Sinipok:K-5<sup>th</sup></b>		<b>Intermediate:3<sup>rd</sup>-5<sup>th</sup></b>	
<b>1<sup>st</sup> Instructional Block 8:30 a.m. – 10:00 a.m.</b>		<b>1<sup>st</sup> Instructional Block 8:30 a.m. – 10:15 a.m.</b>	
<b>Primary Recess 10:00 a.m. – 10:15 a.m</b>		<b>Intermediate Recess 10:15 a.m. – 10:30 a.m.</b>	
<b>2<sup>nd</sup> Instructional Block 10:15 a.m-11:15 a.m</b>		<b>2<sup>nd</sup> Instructional Block 10:30 a.m.-12:00 p.m.</b>	
<b>Primary Lunch 11:15 a.m-12:00 p.m.</b>		<b>Intermediate Lunch 12:00 p.m.-12:45 p.m.</b>	
<b>3<sup>rd</sup> Instructional Block 12:00 p.m. -2:43 p.m.</b>		<b>3<sup>rd</sup> Instructional Block 12:45 p.m.-2:43 p.m.</b>	
<b>2:43 p.m. Student Dismissal</b>			
<b>2:53 p.m. Gates Open for Car-riders/Walkers</b>			

# SY 24-25 Bell Schedule



## Talofoto Elementary School

# TALOFOFO ELEMENTARY SCHOOL

## BELL SCHEDULE

### SY24-25

SUBJECT /ACTIVITY	TIME	DURATION MINUTES
GATES OPEN	7:15	30
BREAKFAST	7:30 - 8:15	45
TARDY BELL	8:30	
READING/LA INSTRUCTIONAL BLOCK: K/3 <sup>RD</sup>	8:30 - 10:15	105
READING/LA INSTRUCTIONAL BLOCK: 1 <sup>ST</sup> /4 <sup>TH</sup>	8:30 - 10:30	120
READING/LA INSTRUCTIONAL BLOCK: 2 <sup>ND</sup> /5 <sup>TH</sup>	8:30 - 10:45	135
1 <sup>ST</sup> RECESS: K/3 <sup>RD</sup>	10:15 - 10:30	15
2 <sup>ND</sup> RECESS: 1 <sup>ST</sup> /4 <sup>TH</sup>	10:30 - 10:45	
3 <sup>RD</sup> RECESS: 2 <sup>ND</sup> /5 <sup>TH</sup>	10:45 - 11:00	
MATH + OTHERS INSTRUCTIONAL BLOCK: K/3 <sup>RD</sup>	10:30 - 11:30	60
MATH + OTHERS INSTRUCTIONAL BLOCK: 1 <sup>ST</sup> /4 <sup>TH</sup>	10:45 - 12:00	75
MATH + OTHERS INSTRUCTIONAL BLOCK: 2 <sup>ND</sup> /5 <sup>TH</sup>	11:00 - 12:30	90
1 <sup>ST</sup> LUNCH: K/3 <sup>RD</sup>	11:30 - 12:15	45
2 <sup>ND</sup> LUNCH: 1 <sup>ST</sup> /4 <sup>TH</sup>	12:00 - 12:45	
3 <sup>RD</sup> LUNCH: 2 <sup>ND</sup> /5 <sup>TH</sup>	12:30 - 1:15	
CONTENT INSTRUCTIONAL BLOCK: K/3 <sup>RD</sup>	12:15 - 2:43	148
CONTENT INSTRUCTIONAL BLOCK: 1 <sup>ST</sup> /4 <sup>TH</sup>	12:45 - 2:43	118
CONTENT INSTRUCTIONAL BLOCK: 2 <sup>ND</sup> /5 <sup>TH</sup>	1:15 - 2:43	88
DISMISSAL	2:43	

**TALOFOFO ELEMENTARY SCHOOL  
CHAMORU SCHEDULE  
SY24-25**

<b>SAINA BOBBIE TAINATONGO – ROOM 25</b>			
<b>GRADE</b>	<b>DAYS</b>	<b>TIME</b>	<b>FRIDAY</b>
5 <sup>TH</sup> : GUZMAN	MON/WED	9:00-10:00	9:00-9:30
2 <sup>ND</sup> : AGUON	MON/WED	10:05-10:45	1:20-1:40
KINDER: DAMIAN	MON/WED	12:30-1:10	12:20-12:40
4 <sup>TH</sup> : SANTOS	TUES/THURS	9:00-10:00	9:40-10:10
3 <sup>RD</sup> : MANZANO	TUES/THURS	12:20-1:00	1:50-2:10
1 <sup>ST</sup> : BLAS	TUES/THURS	1:30-2:10	12:50-1:10

<b>SINORA ELIZABETH PABLO – ROOM 17</b>			
<b>GRADE</b>	<b>DAYS</b>	<b>TIME</b>	<b>FRIDAY</b>
5 <sup>TH</sup> : DIEGO	MON/WED	9:00-10:00	9:00-9:30
2 <sup>ND</sup> : MAYBERRY	MON/WED	10:05-10:45	1:20-1:40
KINDER: ARCEO	MON/WED	12:30-1:10	12:20-12:40
4 <sup>TH</sup> : CONCEPCION	TUES/THURS	9:00-10:00	9:40-10:10
3 <sup>RD</sup> : MARTINEZ	TUES/THURS	12:20-1:00	1:50-2:10
1 <sup>ST</sup> : CHACO	TUES/THURS	1:30-2:10	12:50-1:10

<b>PLC/CLT SCHEDULE</b>		
<b>GRADE</b>	<b>DAY</b>	<b>TIME</b>
KINDER	MONDAY	12:30-1:10
FIRST	TUESDAY	1:30-2:10
SECOND	MONDAY	10:05-10:45
THIRD	TUESDAY	12:20-1:00
FOURTH	TUESDAY	9:00-10:00
FIFTH	MONDAY	9:00-10:00

# SY 24-25 Bell Schedule



## Tamuning Elementary School



# **TAMUNING ELEMENTARY SCHOOL**

**SY 2024 - 2025**

## **Bell Schedule**

**7:15 a.m.**

Arrival of Students

**FOR SAFETY PURPOSES, STUDENTS MUST NOT BE ON CAMPUS PRIOR TO 7:15 A.M.**

**8:15 a.m.**

Teacher Reporting Time & Class Preparations

**8:30 a.m.**

Instruction Begins

## **MORNING RECESS TIMES**

**10:00-10:15 a.m.**

Primary Morning Recess (2<sup>nd</sup> Grade & 3<sup>rd</sup> Grade)

**10:15-10:30 a.m.**

Intermediate Morning Recess (4<sup>th</sup> Grade & 5<sup>th</sup> Grade)

## **LUNCH PERIODS**

**11:30 a.m.-12:15 p.m.** 2<sup>nd</sup> Grade Lunch Period

**11:45 a.m.-12:30 p.m.** 3<sup>rd</sup> Grade Lunch Period

**12:00 p.m.-12:45 p.m.** 4<sup>th</sup> Grade Lunch Period

**12:15 p.m.-1:00 p.m.** 5<sup>th</sup> Grade Lunch Period

**2:43 p.m.**

Dismissal

**3:30 p.m.**

School Office Closed

# SY 24-25 Bell Schedule



## Upi Elementary School

Upi Elementary School  
SY 2024-2025 Schedule

Building	A	B	C	D	E	G
TIME	KINDER	FIRST	SECOND	THIRD	FOURTH	FIFTH
7:15-8:15	BREAKFAST 7:15-8:15					
8:15-8:30	Homeroom 8:15-8:30					
8:30-8:45	READING 8:30-9:45 <u>CHAMORU</u> (FRI) 8:45-9:05	READING 8:30-9:45 <u>CHAMORU</u> (FRI) 9:15-9:35	READING 8:30-9:45	READING 8:30-10:00	READING 8:30-10:00 <u>CHAMORU</u> (T/TH) 9:00-10:00	READING 8:30-10:00 <u>CHAMORU</u> (M/W) 9:00-10:00
8:45-9:00	RECESS 9:45-10:00					
9:00-9:15	RECESS 10:00-10:15					
9:15-9:30	RECESS 10:00-10:15					
9:30-9:45	RECESS 10:00-10:15					
9:45-10:00	RECESS 10:00-10:15					
10:00-10:15	RECESS 10:00-10:15					
10:15-10:30	CONTENT 10:00-10:45	CONTENT 10:00-10:45	MATH 10:00-11:30 <u>CHAMORU</u> (T/TH) 10:45-11:25 (FRI) 10:45-11:15	ELA 10:15-11:30 <u>CHAMORU</u> (M/W) 10:45-11:25 (F) 10:10-10:30	Reading/ELA 10:15-11:30	Reading/ELA 10:15-11:30
10:30-10:45	LUNCH 10:45-11:30					
10:45-11:00	LUNCH 10:45-11:30					
11:00-11:15	LUNCH 10:45-11:30					
11:15-11:30	LUNCH 10:45-11:30					
11:30-11:45	LUNCH 10:45-11:30					
11:45-12:00	LUNCH 10:45-11:30					
12:00-12:15	MATH 11:30-12:45	MATH 11:30-12:45	LUNCH 11:30-12:15	LUNCH 11:30-12:15	CONTENT 11:30-12:15	CONTENT 11:30-12:15
12:15-12:30	LUNCH 11:30-12:15					
12:30-12:45	LUNCH 11:30-12:15					
12:45-1:00	ELA 12:45-1:45 <u>CHAMORU</u> (T/TH) 1:00-1:40	ELA 12:45-1:45 <u>CHAMORU</u> (M/W) 1:00-1:40	ELA 12:15-1:30	MATH 12:15-1:30	LUNCH 12:15-1:00	LUNCH 12:15-1:00
1:00-1:15	LUNCH 11:30-12:15					
1:15-1:30	LUNCH 11:30-12:15					
1:30-1:45	LUNCH 11:30-12:15					
1:45-2:00	LUNCH 11:30-12:15					
2:00-2:15	LUNCH 11:30-12:15					
2:15-2:30	CONTENT 1:45-2:43	CONTENT 1:45-2:43	CONTENT 1:30-2:43	CONTENT 1:30-2:43	MATH 1:00-2:15 <u>CHAMORU</u> (FRI) 1:15-1:45	MATH 1:00-2:15 <u>CHAMORU</u> (FRI) 1:50-2:15
2:30-2:43	LUNCH 11:30-12:15					

# SY 24-25 Bell Schedule



## Wettengel Elementary School

WETTENGEL ELEMENTARY SCHOOL					
REGULAR SCHOOL SCHEDULE					
SCHOOL YEAR 2024-2025					
Kinder	First	Second	Third	Fourth	Fifth
ELA 8:30-9:30 (60 mins)	ELA 8:30-9:30 (60 mins)	ELA 8:30-9:45 (60 mins)	ELA 8:30-9:45 (60 mins)	ELA 8:30-9:25 (55 mins)	ELA 8:30-10:00 (90 mins)
RECESS 9:30 -9:45	RECESS 9:30-9:45			CHAMORU 9:30-10:00 (30 mins)	
ELA 9:45-10:30 (45 mins)	ELA 9:45-10:30 (45 mins)	RECESS 9:45-10:00	RECESS 9:45-10:00	RECESS 10:00-10:15	RECESS 10:00-10:15
		ELA 10:05-11:05 (60 mins)	ELA 10:00-11:00 (60 mins)	ELA 10:15-11:20 (65 mins)	CHAMORU 10:20-10:50 (30 mins)
LUNCH 10:30-11:15	LUNCH 10:30-11:15	MATH 11:05-11:15 (10 mins)	MATH 11:00-11:15 (15 mins)		ELA 10:50-11:20 (30 mins)
ELA 11:15-11:30 (15 mins)	ELA 11:15-11:30 (15 mins)	LUNCH 11:15-12:00	LUNCH 11:15-12:00	MATH 11:20-12:00 (40 mins)	MATH 11:20-12:00 (40 mins)
MATH 11:30-12:30 (60 mins)	MATH 11:30-12:30 (60 mins)				
OC 12:30-1:15 (45 mins)	CHAMORU 12:40-1:10 (30 mins)	OC 12:50-1:50 (60 mins)	MATH 12:35-1:20 (45 mins)	MATH 12:45 1:05 (20 mins)	MATH 12:45 1:05 (20 mins)
CHAMORU 1:15-1:45 (30 mins)	OC 1:15-2:43 (88 mins)			CHAMORU 1:50-2:20 (30 mins)	OC 1:20-2:43 (83 mins)
OC 1:45-2:43 (58 mins)		OC 2:20-2:43 (23 mins)			
DISMISSAL 2:43pm					